



STRUCTURAL SECTIONS

PRODUCT GUIDE

GRP AUSTRALIA | 2025

CONTENTS

PAGE NUMBER

1.0	COMPANY BRIEF	3
2.0	RESIN BASE	4
3.0	FIRE PROPERTIES	5
4.0	WEATHERING	5
5.0	ENVIRONMENT & DISPOSAL	5
6.0	PRODUCT RANGE	6
6.1	I Beam	6
6.2	H Beam	7
6.3	C Channel	8
6.4	Rectangular Hollow Section	9
6.5	Fibreframe Rectangular Hollow Section	10
6.6	Square Hollow Section	11
6.7	Square Handrail Sleeve	13
6.8	Round Tube	14
6.9	Corrugated Round Tube	16
6.10	Y Beam	17
6.11	Equal Angle	18
6.12	Un-Equal Angle	19
6.13	Top Hat	20
6.14	Stair Nosing	21
6.15	Flat Plate	22
6.16	Flat Strip	23
6.17	Flat Strip (Chamfer Edge)	25
6.18	Flat Strip (Grit)	26
6.19	Round Solid Rod	27
6.20	Square Solid Rod	28
6.21	Kick Plate	29
7.0	CUSTOM STRUCTURAL SECTIONS	30
8.0	PULTRUDED GRATING	31
9.0	CHEMICAL RESISTANT GUIDE	32
10.0	GALLERY	34



1.0 COMPANY BRIEF

GRP Australia is a Brisbane based, owned and operated company. As an independent supplier we source and import FRP pultruded structural sections and FRP grating from trusted quality manufacturers. This enables us to provide our customers with quality products at competitive prices.

The owners of the company, have combined their engineering backgrounds and 65 years of experience in the construction, mineral processing, chemical and waste treatment industries. We have in-house Engineers capable of providing design services to our customers, including the design of custom pultruded shapes to suit client specific requirements.

We are excited to see the growing recognition and use of pultruded products in many industrial and residential applications and are confident this product has many advantages over traditional building products such as timber, steel, and aluminum.

GRP Australia currently stock a selection of the most commonly used pultruded sections and FRP grating however, many more profiles are available for order. Please contact GRP Australia for assistance with custom or specific profiles.

2.0 RESIN BASE

GRP Australia offers four resin systems to accommodate various applications ensuring the optimal utilisation of moulded grating. Resin type should be chosen according to the environment in which the material is intended to be used.

Resin Type	Resin Base	Description	Corrosion Resistance	Flame Spread Rating ASTM E84	Cost
VER-25	Vinyl ester	Superior corrosion resistance and retardant.	Excellent	Class 1, 25 or less	
VER-10	Vinyl ester	Superior corrosion resistance and enhanced retardant	Excellent	Class 1, 10 or less	Most Expensive
IFR-25	Isophthalic polyester	Industrial grade corrosion resistance and fire retardant	Very good	Class 1, 25 or less	Least Expensive
IFR-10	Isophthalic polyester	Industrial grade corrosion resistance and extra fire retardant	Very good	Class 1, 10 or less	



VER-25

Primarily used in grey water, mining, plating and petrochemical applications. Type VEFR-25 is designed to withstand harsh chemical environments where the grating is subject to direct contact with harsh chemicals.



IFR-25

Type IFR-25 provides an intermediate level of chemical resistance suitable for grating exposed to splash and spill contact with hard chemicals. With a flame spread rating of 25 or less, it is an ideal general purpose resin with a reduced cost.



VER-10

Type VEFR-10 is manufactured with an enhanced flame spread rating of 10 or less for applications that require additional flame resistance i.e *offshore platform*.



IFR-10

Type VEFR-10 has an enhanced flame spread rating of 10. It is manufactured to the same high quality as Type IFR-25.

3.0 FIRE PROPERTIES

All GRP Australia products contain fire retardants, typically alumina trihydrate. Our standard profiles are classified as class 1,25 or less flame spread index to ASTM E84. The ultimate fire rating properties of GRP pultruded products will depend on the composite mix. Pultruded profiles tested to AS 1530.3 achieved the following results:

	Range	IFR10	IFR 25
Spread of Flame index	(0-10)	0	2
Heat Evolved Index	(0-10)	1	5
Smoke developed Index	(0-10)	5	5
Ignitability Index	(0-20)	13	10

4.0 WEATHERING

All GRP Australia products have UV inhibitors to protect against UV light, but extended exposure will eventually damage the surface. To prolong the durability of GRP members exposed to direct sunlight, it is recommended to apply a protective coating.

5.0 ENVIRONMENT & DISPOSAL

FRP pultruded profiles (fiberglass–reinforced unsaturated polyesters) are a stable and virtually non-degradable material. Offcuts and profiles which are at the end of their service life, can be disposed as normal industrial waste as the materials do not give off substances which can harm the environment.

FRP offer significant CO2 emission benefits compared to traditional materials such as steel or concrete during construction and manufacturing. The lightweight nature of FRP reduces transportation emissions, while their durability and corrosion resistance result in longer lifespans, minimizing the need for frequent replacements and associated emissions from production.



6.1 I BEAM

I Beams are commonly used in construction and structural applications for their high load-bearing capacity, providing strong support for buildings, bridges, and frameworks.

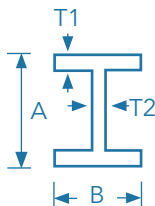

Standard Stock Length



Surface Finish



Smooth

Colours



RAL7046
Telegrey2

IFR25



RAL7040
Window Grey

VER25

PROFILE RANGE

Non-Stocked item (MOQ of 100 lineal metres + 10-12 week lead time)

Profile	Type	Dimension (mm)	Weight (kg/m)
	I Beam	A x B x T1 x T2	
IB	IB32x15x6.4x4.0	32 x 15 x 6.4 x 4.0	0.51
IB	IB38x30x3.0x3.0	38 x 30 x 3.0 x 3.0	0.53
IB	IB102x50x6.4x6.4	102 x 50 x 6.4 x 6.4	2.40
IB	IB102x50x8.0x8.0	102 x 50 x 8.0 x 8.0	3.00
IB	IB140x70x6.35x6.35	140 x 70 x 6.35 x 6.35	3.30
IB	IB152x76x6.4x6.4	152 x 76 x 6.4 x 6.4	3.59
IB	IB152x76x9.5x9.5	152 x 76 x 9.5 x 9.5	5.32
IB	IB152x127x9.5x9.5	152 x 127 x 9.5 x 9.5	7.10
IB	IB152x127x12.7x12.7	152 x 127 x 12.7 x 12.7	9.20
IB	IB180x45x9.0x12.0	180 x 45 x 9.0 x 12.0	5.40
IB	IB203x102x9.5x9.5	203 x 102 x 9.5 x 9.5	7.20
IB	IB203x102x12.7x12.7	203 x 102 x 12.7 x 12.7	9.50
IB	IB240x120x12x12	240 x 120 x 12 x 12	10.50
IB	IB254x127x9.5x9.5	254 x 127 x 9.5 x 9.5	9.00
IB	IB254x127x12.7x12.7	254 x 127 x 12.7 x 12.7	11.90
IB	IB305x152x9.5x9.5	305 x 152 x 9.5 x 9.5	10.74
IB	IB305x152x12.7x12.7	305 x 152 x 12.7 x 12.7	14.30

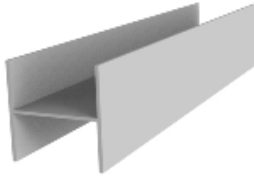

6.2 H BEAM

H Beams are widely used in structural applications across various industries due to their strength, lightweight nature, and resistance to corrosion and environmental degradation

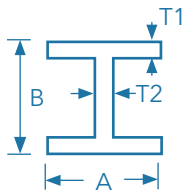

Standard Stock Length



Surface Finish



Smooth

Colours



RAL7046
Telegrey2

IFR25



RAL7040
Window Grey

VER25

PROFILE RANGE

Non-Stocked item (MOQ of 100 lineal metres + 10-12 week lead time)

Profile	Type	Dimension (mm)	Weight (kg/m)
	H Beam	A x B x T1 x T2	
HB	HB76x76x6.4	76 x 76 x 6.4 x 6.4	2.67
HB	HB102x102x6.4	102 x 102 x 6.4 x 6.4	3.59
HB	HB102x102x8.0	102 x 102 x 8.0 x 8.0	4.50
HB	HB152x152x6.4	152 x 152 x 6.4 x 6.4	5.43
HB	HB152x152x9.5	152 x 152 x 9.5 x 9.5	8.10
HB	HB203x203x9.5	203 x 203 x 9.5 x 9.5	10.80
HB	HB203x203x12.7	203 x 203 x 12.7 x 12.7	14.36
HB	HB203x203x6.4	203 x 203 x 6.4 x 6.4	7.50
HB	HB254x254x9.5	254 x 254 x 9.5 x 9.5	13.60
HB	HB254x254x12.7	254 x 254 x 12.7 x 12.7	18.04
HB	HB305x305x12.7	305 x 305 x 12.7 x 12.7	21.50



6.3 C CHANNEL

C Channels are typically used in structural applications, such as framing, support systems, and bracing, due to their ability to provide stability and strength with a relatively lightweight profile.

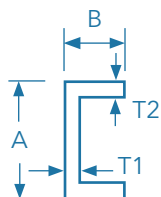

Standard Stock Length

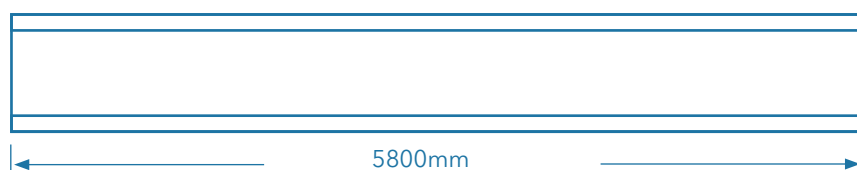

Surface Finish



Smooth

Colours



RAL7046
Telegrey2

IFR25

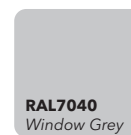

RAL7040
Window Grey

VER25

PROFILE RANGE

Non-Stocked item (MOQ of 100 lineal metres + 10-12 week lead time)

Profile	Type	Dimension (mm)	Weight (kg/m)
	C Channel	A x B x T1 x T2	
C	C25x14x3.0	25 x 14 x 3.0 x 3.0	0.28
C	C52x50x6.0	52 x 50 x 6.0 x 6.0	1.63
C	C60x50x5.0	60 x 50 x 5.0 x 5.0	1.44
C	C75x35x5	75 x 35 x 5.0 x 5.0	1.37
C	C76x38x6.4	76 x 38 x 6.4 x 6.4	1.70
C	C102x44x4.8	102 x 44 x 4.8 x 4.8	1.65
C	C102x44x6.4	102 x 44 x 6.4 x 6.4	2.10
C	C150x100x6.4	150 x 100 x 6.4 x 6.4	4.10
C	C152x42x4.8	152 x 42 x 4.8 x 4.8	2.03
C	C152x42x9.5	152 x 42 x 9.5 x 9.5	3.95
C	C152x50x9.5	152 x 50 x 9.5 x 9.5	4.35
C	C203x56x9.5	203 x 56 x 9.5 x 9.5	5.34
C	C203x102x12.7	203 x 102 x 12.7 x 12.7	9.20
C	C254x70x12.7	254 x 70 x 12.7 x 12.7	8.90
C	C305x76.0x12.7	305 x 76.2 x 12.7 x 12.7	10.50



6.4 RECTANGULAR HOLLOW SECTION

Rectangular hollow sections are commonly used in construction and engineering for structural support, frameworks, and load-bearing applications, providing strength and versatility with a flat surface profile.

Standard Stock Length

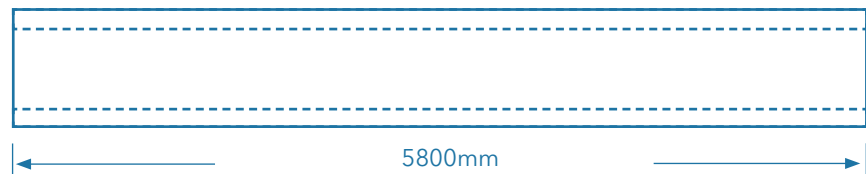
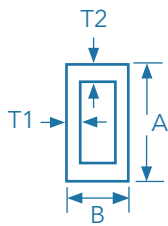

Surface Finish



Smooth

Colours



RAL7046
Telegrey2

IFR25



RAL7040
Window Grey

VER25

PROFILE RANGE

Non-Stocked item (MOQ of 100 lineal metres + 10-12 week lead time)

Profile	Type	Dimension (mm)	Weight (kg/m)
	Rectangular Section	A x B x T1 x T2	
RHS	RHS51x25x3.0	51 x 25 x 3.0 x 3.0	0.79
RHS	RHS51x25x6.4	51 x 25 x 6.4 x 6.4	1.54
RHS	RHS51x38x5.0	51 x 38 x 4.0 x 4.0	1.22
RHS	RHS75x38x4.0	75 x 38 x 4.0 x 4.0	1.70
RHS	RHS80x60x5.0	80 x 60 x 5.0 x 5.0	2.50
RHS	RHS91x38x4	91 x 38 x 4.0 x 4.0	1.78
RHS	RHS100x75x5.0	100 x 75 x 5.0 x 5.0	3.25
RHS	RHS101.6x50.80x6.35	101.6 x 50.8 x 6.35 x 6.35	3.45
RHS	RHS120x45x3.0	120 x 45 x 3.0 x 3.0	2.00
RHS	RHS125x75x6.0	125 x 75 x 6.0 x 6.0	4.35
RHS	RHS150x100x6.35	150 x 100 x 6.35 x 6.35	5.80
RHS	RHS175x50x9.0	175 x 50 x 9.0 x 9.0	7.00



6.5 FIBREFRAME RECTANGULAR HOLLOW SECTIONS

Fibreframe Rectangular hollow sections are commonly used in outdoor decking and engineering for structural support, frameworks, and load-bearing applications, providing strength and versatility with a flat surface profile.

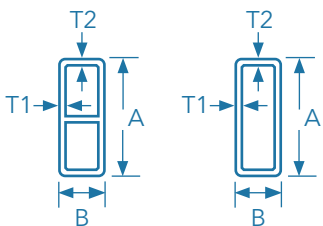

FF200x50
(PROFILE)

FF140x45
FF120x45
FF90x45
(PROFILE)

Standard Stock Length



Surface Finish



Smooth

Colours



IFR25



VER25

PROFILE RANGE

Non-Stocked item (MOQ of 100 lineal metres + 10-12 week lead time)

Profile	Type	Dimension (mm)	Weight (kg/m)
	Rectangular Section	A x B x T1 x T2	
FF	FF90x45x5x4	90 x 45 x 5 x 4	2.11
FF	FF120x45x6x4	120 x 45 x 6 x 4	2.86
FF	FF140x45x6x4	140 x 45 x 6 x 4	2.98
FF	FF200x50x8x5	200 x 50 x 8 x 5	5.61

*End Caps & Brackets are available for profiles in this range - refer to GRP-GU-08 - Brackets & End Caps Brochure for more details



6.6 SQUARE HOLLOW SECTION

Square hollow sections are used in construction and engineering for structural support, frameworks, and architectural applications, offering a balance of strength, lightweight properties, and aesthetic appeal.

Standard Stock Length

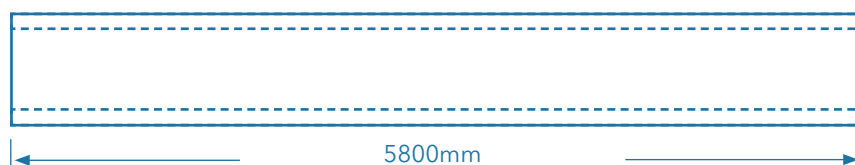
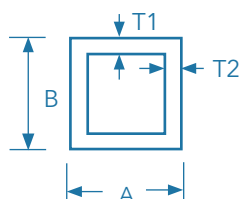

Surface Finish



Smooth

Colours



RAL7046
Telegrey2

IFR25



RAL7040
Window Grey

VER25



RAL1003
Signal Yellow

VER25

PROFILE RANGE

Non-Stocked item (MOQ of 100 lineal metres + 10-12 week lead time)

Profile	Type	Dimension (mm)	Weight (kg/m)
	Square Tube	A x B x T1 x T2	
SHS	SHS25x25x3.2	25 x 25 x 3.2 x 3.2	0.53
SHS	SHS25x25x6.4	25 x 25 x 6.4 x 6.4	0.90
SHS	SHS32x32x3.2	32 x 32 x 3.2 x 3.2	0.70
SHS	SHS32x32x6.4	32 x 32 x 6.4 x 6.4	1.24
SHS	SHS38x38x3.2	38 x 38 x 3.2 x 3.2	0.85
SHS	SHS38x38x5.0	38 x 38 x 5.0 x 5.0	1.25
SHS	SHS38x38x6.4	38 x 38 x 6.4 x 6.4	1.54
SHS	SHS50x50x3.2	50 x 50 x 3.2 x 3.2	1.14
SHS	SHS50x50x3.5	50 x 50 x 3.5 x 3.5	1.24
SHS	SHS50x50x4.0	50 x 50 x 4.0 x 4.0	1.42
SHS	SHS50x50x5.0	50 x 50 x 5.0 x 5.0	1.74
SHS	SHS50x50x6.4	50 x 50 x 6.4 x 6.4	2.12
SHS	SHS64x64x3.2	64 x 64 x 3.2 x 3.2	1.48

STRUCTURAL SECTIONS

PRODUCT GUIDE

12

Non-Stocked item (MOQ of 100 lineal metres + 10-12 week lead time)

Profile	Type	Dimension (mm)	Weight (kg/m)
	Square Tube	A x B x T1 x T2	
SHS	SHS64x64x4.4	64 x 64 x 4.4 x 4.4	1.97
SHS	SHS64x64x6.4	64 x 64 x 6.4 x 6.4	2.80
SHS	SHS76x76x3.2	76 x 76 x 3.2 x 3.2	1.77
SHS	SHS76x76x5.0	76 x 76 x 5.0 x 5.0	2.70
SHS	SHS76x76x6.4	76 x 76 x 6.4 x 6.4	3.39
SHS	SHS76x76x9.5	76 x 76 x 9.5 x 9.5	4.89
SHS	SHS89x89x6.4	89 x 89 x 6.4 x 6.4	3.95
SHS	SHS90x90x5.0	90 x 90 x 5.0 x 5.0	3.50
SHS	SHS90x90x5.0	90 x 90 x 6.4 x 6.4	4.10
SHS	SHS100x100x8.0	100 x 100 x 8.0 x 8.0	6.00
SHS	SHS100x100x10	100 x 100 x 10 x 10	6.90
SHS	SHS101x101x3.2	101 x 101 x 3.2 x 3.2	2.38
SHS	SHS101x101x5.0	101 x 101 x 5.0 x 5.0	3.61
SHS	SHS101x101x6.4	101 x 101 x 6.4 x 6.4	4.61
SHS	SHS125x125x6.4	125 x 125 x 6.4 x 6.4	5.90
SHS	SHS125x125x8.0	125 x 125 x 8.0 x 8.0	7.30
SHS	SHS152x152x6.4	152 x 152 x 6.4 x 6.4	7.10
SHS	SHS152x152x9.5	152 x 152 x 9.5 x 9.5	10.4
SHS	SHS152x152x12.7	152 x 152 x 12.7 x 12.7	13.5

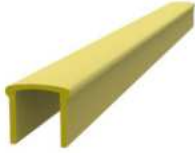

6.7 SQUARE HANDRAIL SLEEVE

Square handrail sleeves provide a sleek and durable solution for enhancing the appearance and longevity of square handrails.

Standard Stock Length

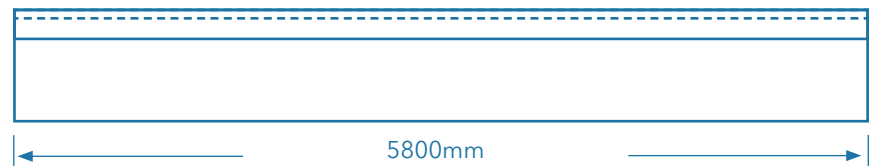
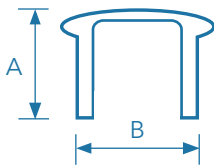

Surface Finish



Smooth

Colours



RAL1003
Signal Yellow

VER25

PROFILE RANGE

Non-Stocked item (MOQ of 100 lineal metres + 10-12 week lead time)

Profile	Type	Dimension (mm)	Weight (kg/m)
	Square Tube	A x B x T1 x T2	
HR	HR62x59x4.5	62x59x4.5	1.50
HR	HR62x60x5	62 x 60 x 5.0	1.70



6.8 ROUND TUBE

Round tubes are used in various applications, including structural supports, piping systems, electrical conduits, and recreational equipment, due to their strength, corrosion resistance, and lightweight properties.

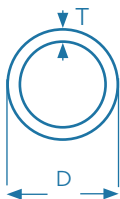

Standard Stock Length

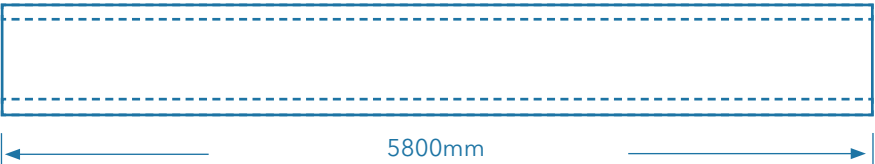

Surface Finish



Smooth

Colours



RAL7046
Telegrey2

IFR25



RAL7040
Window Grey

VER25



RAL1003
Signal Yellow

VER25



RAL9003
Signal White

VER25

PROFILE RANGE

Non-Stocked item (MOQ of 100 lineal metres + 10-12 week lead time)

Profile	Type	Dimension (mm)	Weight (kg/m)
	Round Tube	A x B x T1 x T2	
RT	RT25x3.2	25 x 3.2	0.44
RT	RT26x3.0	26 x 3.0	0.42
RT	RT26x4.8	26 x 4.8	0.63
RT	RT32x3.2	32 x 3.2	0.55
RT	RT32x5.0	32 x 5.0	0.81
RT	RT32x6.0	32 x 6.0	0.96
RT	RT32x9.5	32 x 9.5	1.27
RT	RT38x3.2	38 x 3.2	0.65
RT	RT38x4.0	38 x 4.0	0.81
RT	RT38x5	38 x 5.0	1.00
RT	RT38x6.4	38 x 6.4	1.18
RT	RT41x4.5	41 x 4.5	0.98
RT	RT42x3.2	42 x 3.2	0.70
RT	RT42x5.0	42 x 5.0	1.11
RT	RT42x6.4	42 x 6.4	1.45
RT	RT48x6.4	48 x 6.4	1.58
RT	RT50x3.2	50 x 3.2	0.84
RT	RT50x3.5	50 x 3.5	0.96

Non-Stocked item (MOQ of 100 lineal metres + 10-12 week lead time)

Profile	Type	Dimension (mm)	Weight (kg/m)
	Round Tube	A x B x T1 x T2	
RT	RT50x4.0	50 x 4.0	1.10
RT	RT50x5.0	50 x 5.0	1.34
RT	RT50x6.4	50 x 6.4	1.67
RT	RT50.8x3.2	50.8 x 3.2	0.68
RT	RT50.8x6.4	50.8 x 6.4	1.70
RT	RT60x5.5	60 x 5.5	1.85
RT	RT60x6.5	60 x 6.5	2.10
RT	RT64x3.5	64 x 3.5	1.26
RT	RT64x6.4	64 x 6.4	2.38
RT	RT70x8.0	70 x 8.0	3.20
RT	RT75x4.2	75 x 4.2	1.80
RT	RT76x6.4	76 x 6.4	2.64
RT	RT85x5.0	85 x 5.0	2.40
RT	RT89x5.0	89 x 3.2	1.54
RT	RT89x5.0	89 x 5.0	2.51
RT	RT89x6.4	89 x 6.4	3.13
RT	RT99x5.0	99 x 5.0	2.81
RT	RT101x4.3	101 x 4.3	2.60
RT	RT101x5.0	101 x 5.0	2.90
RT	RT101x6.4	101 x 6.4	3.62
RT	RT150x5.0	150 x 5.0	4.35
RT	RT150x6.4	150 x 6.4	5.50
RT	RT150x9.5	150 x 9.5	8.00



6.9 CORRUGATED ROUND TUBE

Corrugated round tubes are used for flexible and durable applications such as conduit for wiring, drainage systems, and protective casings, offering strength and flexibility for various environmental conditions.



Stock Length



Surface Finish



Smooth

Colours



VER25

PROFILE RANGE

Non-Stocked item (MOQ of 100 lineal metres + 10-12 week lead time)

Profile	Type	Dimension (mm)	Weight (kg/m)
	Corrugated Round Tube	A x B x T1 x T2	
RTC	RTC19x32x6.4	19 x 32 x 6.4	1.11
RTC	RTC25x32x3.5	25 x 32 x 3.5	0.66
RTC	RTC22x32x5.0	22 x 32 x 5.0	0.99



6.10 Y BEAM

Y Beam profiles offer a versatile and robust structural solution, designed for strength and efficiency in a wide range of construction applications

Standard Stock Length

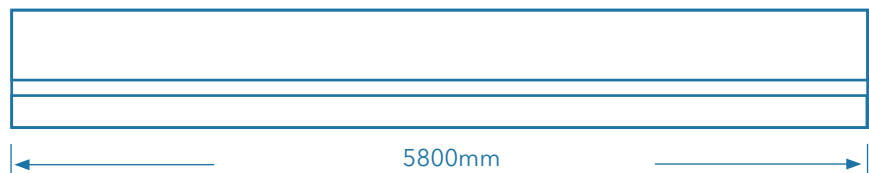
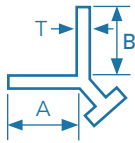

Surface Finish



Smooth

Colours



RAL7046
Telegrey2

IFR25



RAL7040
Window Grey

VER25

PROFILE RANGE

Non-Stocked item (MOQ of 100 lineal metres + 10-12 week lead time)

Profile	Type	Dimension (mm)	Weight (kg/m)
	Y Beam	A x B x T1 x T2	
YB	YB25x38x6.4	25 x 38 x 6.4	1.40
YB	YB38x38x6.4	38 x 38 x 6.4	1.60
YB	YB50x38x6.4	50 x 38 x 6.4	1.70

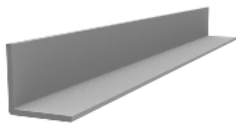

6.11 EQUAL ANGLE

Equal angles are used in construction and structural applications for their versatility in framing, supports, and braces, providing balanced strength and stability in various configurations.

Standard Stock Length

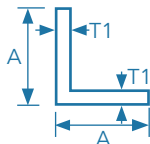

Surface Finish



Smooth

Colours



IFR25



VER25

PROFILE RANGE

Non-Stocked item (MOQ of 100 lineal metres + 10-12 week lead time)

Profile	Type	Dimension (mm)	Weight (kg/m)
	Equal Angle	A x B x T1 x T2	
EA	EA25x25x3.2	25 x 25 x 3.2 x 3.2	0.33
EA	EA25x25x6.4	25 x 25 x 6.4 x 6.4	0.56
EA	EA30x30x5.0	30 x 30 x 5.0 x 5.0	0.57
EA	EA32x32x4.0	32 x 32 x 4.0 x 4.0	0.42
EA	EA38x38x5.0	38 x 38 x 5.0 x 5.0	0.68
EA	EA38x38x6.4	38 x 38 x 6.4 x 6.4	0.85
EA	EA50x50x3.2	50 x 50 x 3.2 x 3.2	0.62
EA	EA50x50x6.4	50 x 50 x 6.4 x 6.4	1.14
EA	EA76x76x4.8	76 x 76 x 4.8 x 4.8	1.38
EA	EA76x76x6.4	76 x 76 x 6.4 x 6.4	1.77
EA	EA76x76x9.5	76 x 76 x 9.5 x 9.5	2.57
EA	EA76x76x12.7	76 x 76 x 12.7 x 12.7	3.40
EA	EA101x101x6.4	101 x 101 x 6.4 x 6.4	2.50
EA	EA101x101x8.0	101 x 101 x 8.0 x 8.0	2.95
EA	EA101x101x9.5	101 x 101 x 9.5 x 9.5	3.48
EA	EA101x101x12.7	101 x 101 x 12.7 x 12.7	4.57
EA	EA152x152x6.4	152 x 152 x 6.4 x 6.4	3.62
EA	EA152x152x9.5	152 x 152 x 9.5 x 9.5	5.42
EA	EA152x152x12.7	152 x 152 x 12.7 x 12.7	7.01

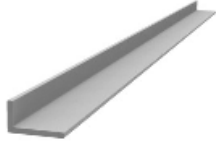

6.12 UNEQUAL ANGLE

Unequal angles are used in structural applications for their ability to provide support and stability in non-symmetrical configurations, allowing for tailored reinforcement and framing solutions.

Standard Stock Length

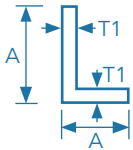

Surface Finish



Smooth

Colours



RAL7046
Telegrey2

IFR25



RAL7040
Window Grey

VER25

PROFILE RANGE

Non-Stocked item (MOQ of 100 lineal metres + 10-12 week lead time)

Profile	Type	Dimension (mm)	Weight (kg/m)
	Un-Equal Angle	A x B x T1 x T2	
UA	UA40x22x4.0	40 x 22 x 4.0 x 4.0	0.45
UA	UA50x40x6.35	50 x 40 x 6.35 x 6.35	1.20
UA	UA100x50x6.4	100 x 50 x 6.4 x 6.4	1.80
UA	UA145x76x10	145 x 76 x 10 x 10	3.85
UA	UA170x76x9.5	170 x 76 x 9.5 x 9.5	4.40
UA	UA254x40x6.4	254 x 40 x 6.4 x 6.4	3.61



6.13 TOP HAT

Top Hat construction profiles are lightweight, durable structural components used in construction projects for cladding, roofing, and facade support, offering exceptional strength and versatility.

Standard Stock Length

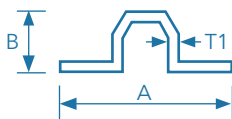

Surface Finish



Smooth

Colours



RAL7046
Telegrey2

IFR25



RAL7040
Window Grey

VER25

PROFILE RANGE

Non-Stocked item (MOQ of 100 lineal metres + 10-12 week lead time)

Profile	Type	Dimension (mm)	Weight (kg/m)
	Top Hat	A x B x T1 x T2	
TH	TH90x30x4.0	90 x 30 x 4.0	1.03

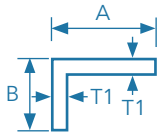

6.14 STAIR NOSING

Separate stair nosing with grit provides enhanced safety and durability, ensuring slip-resistant performance for high-traffic stairways.

Standard Stock Length



Surface Finish



Fine Grit

Colours



RAL9004
Signal Black

IFR25



RAL1003
Signal Yellow

IFR25

PROFILE RANGE

Non-Stocked item (MOQ of 100 lineal metres + 10-12 week lead time)

Profile	Type	Dimension (mm)	Weight (kg/m)
	Stair Nosing	A x B x T1 x T2	
SN	SN70x30x3.2	70x30x3.2	0.29

6.15 FLAT PLATE



Flat plates are used in construction and industrial applications for their lightweight, corrosion-resistant, and high-strength properties, making them ideal for flooring, panels, and structural supports.



Standard Stock Length



Surface Finish



Smooth

Colours



RAL7046
Telegrey2

IFR25



RAL7040
Window Grey

VER25

PROFILE RANGE

Non-Stocked item (MOQ of 100 lineal metres + 10-12 week lead time)

Profile	Type	Dimension (mm)	Weight (kg/m)
	Flat Plate	A x B x T1 x T2	
FP	FP3.2x1000	3.2 x 1000	6.18
FP	FP3.2x1220	3.2 x 1220	7.42
FP	FP4.0x800	4.0 x 800	6.20
FP	FP4.0x1200	4.0 x 1200	9.19
FP	FP4.8x1000	4.8 x 1000	9.30
FP	FP5.0x440	5.0 x 440	4.25
FP	FP5.0x1220	5.0 x 1220	11.8
FP	FP6.4x1220	6.4 x 1220	14.84
FP	FP9.5x1220	9.5 x 1220	22.02
FP	FP12.7x1220	12.7 x 1220	29.44
FP	FP16x1220	16 x 1220	37.20
FP	FP19x1220	19 x 1220	44.10
FP	FP25.4x1220	25.4 x 1222	59.00

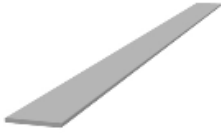

6.16 FLAT STRIP

Flat strips are used in various applications, including reinforcement, framing, and bracing, for their flexibility, ease of installation, and ability to provide structural support and alignment.

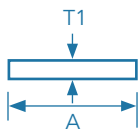

Standard Stock Length

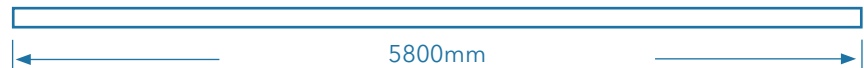

Surface Finish



Smooth

Colours



RAL7046
Telegrey2

IFR25



RAL7040
Window Grey

VER25

PROFILE RANGE

Non-Stocked item (MOQ of 100 lineal metres + 10-12 week lead time)

Profile	Type	Dimension (mm)	Weight (kg/m)
	Flat Strip	A x B x T1 x T2	
FS	FS19x6.4	19 x 6.4	0.25
FS	FS19x22	19 x 22	0.85
FS	FS25.4x8.0	25.4 x 8.0	0.40
FS	FS30x3.0	30 x 3.0	0.18
FS	FS30x6.4	30 x 6.4	0.37
FS	FS35x8.0	35 x 8.0	0.54
FS	FS35x5.0	35 x 5.0	0.37
FS	FS38x8.0	38 x 8.0	0.60
FS	FS38x15.0	38 x 15.0	1.12
FS	FS40x8.0	40 x 8.0	0.62
FS	FS40x10.0	40 x 10.0	0.79
FS	FS46x6.4	46 x 6.4	0.58
FS	FS50x2.0	50 x 2.0	0.25
FS	FS50x4	50 x 4.0	0.38
FS	FS50x6.0	50 x 6.0	0.59
FS	FS50x8.0	50 x 8.0	0.76
FS	FS50x15.0	50 x 15.0	1.43
FS	FS50x25.0	50 x 25.0	2.5

STRUCTURAL SECTIONS

PRODUCT GUIDE

24

Non-Stocked item (MOQ of 100 lineal metres + 10-12 week lead time)

Profile	Type	Dimension (mm)	Weight (kg/m)
	Round-tube	D X T	
FS	FS60x2.0	60 x 2.0	0.24
FS	FS60x4.0	60 x 4.0	0.48
FS	FS64x4.8	64 x 4.8	0.60
FS	FS64x15	64 x 15	1.81
FS	FS70x4	70 x 4.0	0.55
FS	FS76x9.5	76 x 9.5	1.42
FS	FS76x14	76 x 14	2.05
FS	FS100x10.0	100 x 10.0	1.95
FS	FS100x25.0	100 x 25.0	4.85
FS	FS102x3.2	102 x 3.2	0.63
FS	FS102x5.0	102 x 5.0	0.97
FS	FS102x6.4	102 x 6.4	1.30
FS	FS120x10.0	120 x 10.0	2.40
FS	FS127x6.4	127 x 6.4	1.54
FS	FS152x10.0	152 x 10.0	2.92
FS	FS152x20.0	152 x 20.0	5.90
FS	FS190x15.0	190 x 15.0	5.42
FS	FS250x12.0	250 x 12.0	5.70
FS	FS280x10.0	280 x 10.0	5.32
FS	FS300x24.0	300 x 24.0	14.4
FS	FS355x5.0	355 x 5.0	3.5

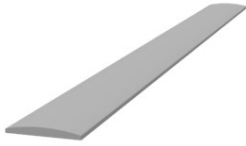

6.17 FLAT STRIP (CHAMFERED EDGE)

Flat strips are used in various applications, including reinforcement, framing, and bracing, for their flexibility, ease of installation, and ability to provide structural support and alignment.

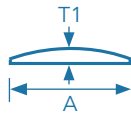

Standard Stock Length



Surface Finish



Smooth

Colours



RAL7046
Telegrey2

IFR25



RAL7040
Window Grey

VER25

PROFILE RANGE

Non-Stocked item (MOQ of 100 lineal metres + 10-12 week lead time)

Profile	Type	Dimension (mm)	Weight (kg/m)
	Flat Strip Chamfered Edge	A x B x T1 x T2	
FSC	FSC50x3.2	50 x 3.2	0.29
FSC	FSC60x3.2	60 x 3.2	0.36
FSC	FSC70x4.0	70 x 4.0	0.54
FSC	FSC90x3.2	90 x 3.2	0.54
FSC	FSC100x3.2	100 x 3.2	0.60
FSC	FSC120x3.0	120 x 3.0	0.70



6.18 FLAT STRIP

(GRIT)

Flat strips are used in various applications, including reinforcement, framing, and bracing, for their flexibility, ease of installation, and ability to provide structural support and alignment.

Standard Stock Length

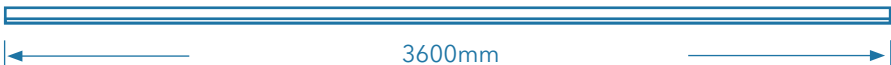

Surface Finish



Fine Grit

Colours



IFR25



IFR25

PROFILE RANGE

Non-Stocked item (MOQ of 100 lineal metres + 10-12 week lead time)

Profile	Type	Dimension (mm)	Weight (kg/m)
	Flat Strip Grit Surface	A x B x T1 x T2	
FSC	FSC50x3.2	50 x 3.2	0.29



6.19 ROUND SOLID ROD

Round Solid Rods are highly durable and corrosion-resistant, making them ideal for reinforcing structures, electrical insulation, & industrial frameworks. Their lightweight design ensure reliable performance in environments such as construction, marine, and electrical industries.

Standard Stock Length



Surface Finish



Smooth

Colours



RAL7047
Telegrey 4

VER25



RAL7040
Window Grey

VER25



RAL1003
Signal Yellow

VER25



RAL9003
Signal White

IFR25

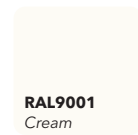

RAL9001
Cream

VER25

PROFILE RANGE

Non-Stocked item (MOQ of 400 lineal metres + 10-12 week lead time)

Profile	Type	Dimension (mm)	Weight (kg/m)
	Round Solid Rod	D	
RSR	RSR4.2	4.2	0.03
RSR	RSR6.0	6.0	0.08
RSR	RSR8.0	8.0	0.10
RSR	RSR9.5	9.5	0.14
RSR	RSR12.7	12.7	0.26
RSR	RSR16	16	0.41
RSR	RSR19	19	0.55
RSR	RSR20	20	0.62
RSR	RSR22	22	0.72
RSR	RSR25.4	25.4	1.00
RSR	RSR31.8	31.8	1.51
RSR	RSR38.0	38.0	2.15

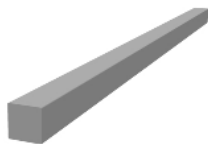

6.20 SQUARE SOLID ROD

Square Solid Rods are highly durable and corrosion-resistant, making them ideal for reinforcing structures, electrical insulation, & industrial frameworks. Their lightweight design ensure reliable performance in environments such as construction, marine, and electrical industries.

Standard Stock Length

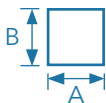

Surface Finish



Smooth

Colours



RAL7046
Telegrey2

IFR25



RAL7040
Window Grey

VER25

PROFILE RANGE

Non-Stocked item (MOQ of 400 lineal metres + 10-12 week lead time)

Profile	Type	Dimension (mm)	Weight (kg/m)
	Square Solid Rod	D	
SSR	SSR25x25	25 x 25	1.23
SSR	SSR32x32	32 x 32	2.00
SSR	SSR38x38	38 x 38	2.80



6.21 KICK PLATE

Kick Rail profiles are designed to seamlessly integrate with FRP hand-rail systems, providing added safety and protection in industrial and commercial applications.

Standard Stock Length

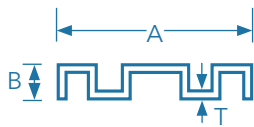
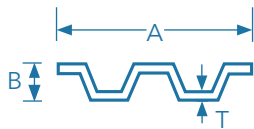

Surface Finish



Smooth

Colours



RAL7046
Telegrey2

IFR25



RAL7040
Window Grey

VER25



RAL1003
Signal Yellow

VER25

PROFILE RANGE

Non-Stocked item (MOQ of 100 lineal metres + 10-12 week lead time)

Profile	Type	Dimension (mm)	Weight (kg/m)
	Kick Plate	D	
KPM	KPM100x16x5	100 x 16 x 5.0 (M Shape)	1.30
KPM	KPM100x15x3.2	100 x 15 x 3.2 (W Shape)	1.60

7.0 CUSTOM STRUCTURAL SECTIONS

In addition to standardised profiles, we offer customised pultruded sections to suit any application. Pultrusions can be customised to meet specific requirements in regard to shape, design and resin matrix. Our in-house engineers are capable of providing design services to eliminate any uncertainty and ensure a sound structural solution.

The lead time on this process is typically 3-5 weeks to produce the profile's pultrusion die & an additional 10 - 12 weeks to manufacture. You will need to keep in mind that a minimum order quantity of 100 lineal metres is required for custom / non-stocked profiles.

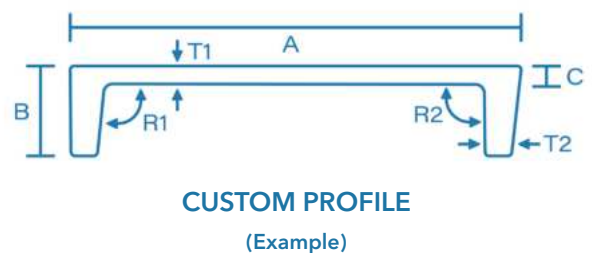
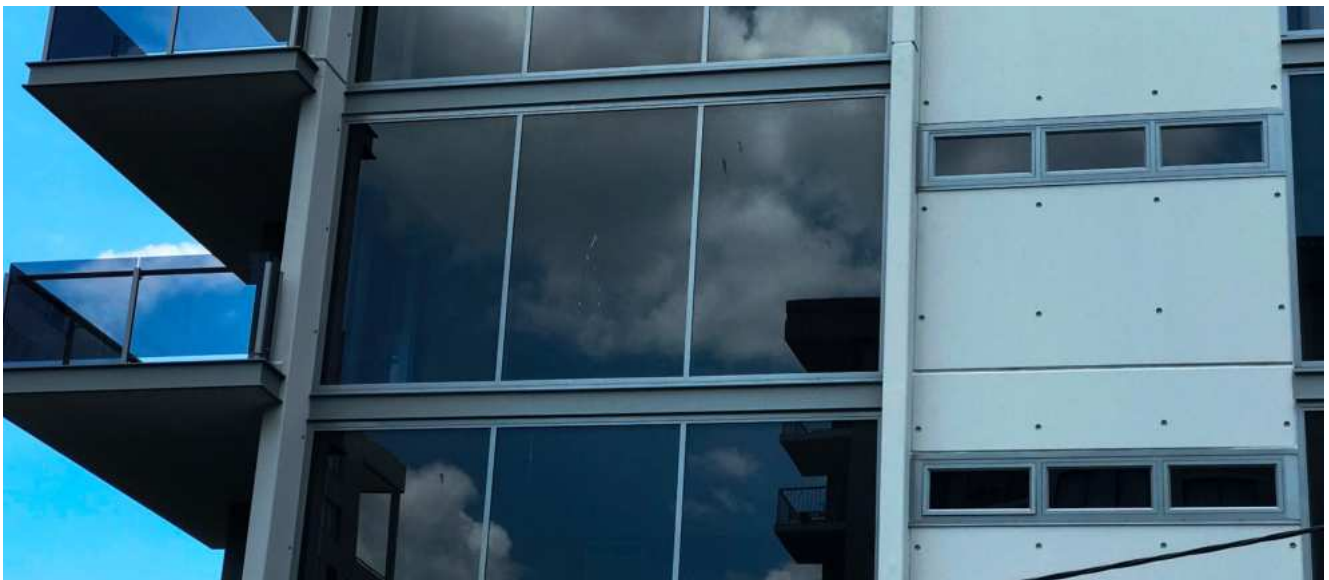

Custom fascia channel profile produced for an architectural feature on a high rise building in Brisbane. Using FRP instead of the originally designed aluminium profile reduced material and installation costs considerably.

8.0 PULTRUDED GRATING

Our pultruded gratings are panels specially designed with 'I', 'T' and 'HL' shaped bearing bars and interlocked with solid rods or tubes. The grating is light-weight, strong, anti-fire chemical and UV resistant.

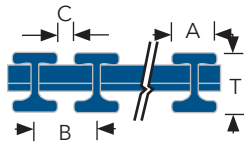

TYPE 'I'

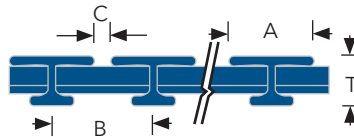

TYPE 'T'

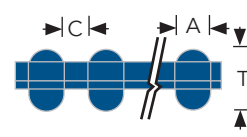

TYPE 'HL'

PROFILE RANGE

Non-Stocked item (MOQ of 100 lineal metres + 10-12 week lead time)

Profile	Type	'T' (mm)	'A' (mm)	'B' (mm)	'C' (mm)	Open area (%)	Weight Kg/m ²
	Pultruded Grating	D					
I - Type	PG-I-4010	25	15	25	10	40	17.8
I - Type	PG-I-5010	25	15	30	15	50	15.1
I - Type	PG-I-6010A	25	15	38	23	60	12.2
I - Type	PG-I-6010B	25	8	19.8	11.8	60	13.7
I - Type	PG-I-4015	38	15	25	10	40	22
I - Type	PG-I-5015	38	15	30	15	50	19.1
I - Type	PG-I-6015	38	15	38	23	60	16.2
I - Type	PG-I-4012	30	15	25	10	40	19.1
I - Type	PG-I-5012	30	15	30	15	50	16.1
I - Type	PG-I-6012	30	15	38	23	60	13.1
I - Type	PG-I-40125	32	15	25	15	40	19.8
I - Type	PG-I-50125	32	15	30	15	50	17.4
I - Type	PG-I-60125	32	15	38	23	60	13.5
I - Type	PG-I-4020	50	15	25	15	40	28.5
I - Type	PG-I-5020	50	15	30	15	50	24.2
I - Type	PG-I-6020	50	15	38	23	60	20.1
T - Type	PG-T-1210	25	38	43.4	5.4	12	15.6
T - Type	PG-T-1810	25	38	50.8	9.5	18	13.8
T - Type	PG-T-2510	25	38	50.8	12.7	25	13.6
T - Type	PG-T-3310	25	41.3	19.7	61	33	11.2
T - Type	PG-T-3810	25	38	61	23	38	11.8
T - Type	PG-T-1215	38	38	43.3	5.2	12	19.6
T - Type	PG-T-2515	38	38	50.8	12.7	25	16.7
T - Type	PG-T-3815	38	38	61	23	38	14.2
T - Type	PG-T-3020	50	25.4	38.1	12.7	33	21.7
T - Type	PG-T-5020	50	25.4	50.8	25.4	50	17.2
HL - Type	PG-HL-4020	50	15	10	10	40	62.8
HL - Type	PG-HL-5020	50	15	15	15	50	52.2
HL - Type	PG-HL-6020	50	15	23	23	60	43.5

9.0 CHEMICAL RESISTANCE GUIDE

This chemical resistance guide provides guidance to engineers for the selection of resin type of pultruded sections to be used in the particular application. The selection of the resin type depends on the following:

- Corrosion environment
- Normal operating chemical concentration
- Normal operating temperature

This table is to be treated as a guide only, further testing or field trials may be required prior to final selection.

		ISOPHTHALIC	VINYL ESTER
Chemical Environment	% CONC.	Max. Temp. °C	Max. Temp. °C
Acetic Acid	0-50	NR	38
Acetone	100	NR	NR
Aluminium Hydroxide	5-20	NR	65
Aluminium Chloride	10	NR	65
Ammonium Bicarbonate	15	NR	50
Ammonium Hydroxide	5-20	NR	50
Ammonium Sulphate	15	50	65
Barium Sulphate	100	NR	38
Benzene	100	NR	NR
Benzoic Acid	5-20	NR	38
Borax	5-20	38	65
Calcium Carbonate	10	NR	38
Calcium Hydroxide	5-20	NR	38
Calcium Hypochlorite	10	NR	50
Calcium Nitrate	5	50	65
Chlorine - Dry Gas	ALL	NR	70
Chlorine Water	10	NR	50
Chromic Acid	50	NR	38
Citric Acid	5-30	50	65
Copper Chloride	5	65	82
Copper Cyanide	5	65	82
Copper Nitrate	ALL	65	NR
Crude Oil	ALL	NR	65
Ethanol Glycol	ALL	38	65
Ferric Chloride	10	50	65
Ferric Nitrate	10	50	65
Ferrous Chloride	ALL	65	70
Fluoro silicic Acid	10	NR	70

		ISOPHTHALIC	VINYL ESTER
Chemical Environment	% CONC.	Max. Temp. °C	Max. Temp. °C
Formaldehyde	5-30	NR	38
Gasoline	ALL	NR	70
Glucose	ALL	65	82
Glycerin	ALL	65	82
Hydrobromic Acid	5-50	38	65
Hydrogen Peroxide	30	NR	50
Lactic Acid	100	NR	70
Lithium Chloride	25	NR	50
Magnesium Chloride	10	38	65
Magnesium Nitrate	10	NR	50
Magnesium Sulphate	10	38	50
Mercuric Chloride	10	50	65
Mercurous Chloride	10	50	65
Nickle Chloride	10	50	65
Nickle Sulphate	10	50	65
Nitric Acid	5-30	NR	38
Oxalic Acid	ALL	65	70
Phosphoric Acid	5-50	38	65
Potassium Chloride	100	NR	50
Potassium Dichromate	100	NR	50
Potassium Nitrate	10	50	65
Potassium Sulphate	10	50	65
Propylene Glycol	100	65	65
Sodium Acetate	ALL	NR	70
Sodium Bisulfate	ALL	65	70
Sodium Bromide	ALL	65	70
Sodium Cyanide	ALL	NR	70
Sodium Hydroxide	0-50	NR	65
Sodium Nitrate	ALL	65	70
Sodium Sulphate	ALL	65	70
Sulphuric Acid	0-30	65	70
Sulphuric Acid	30-50	NR	70
Sulphuric Acid	50-70	NR	50
Tartaric Acid	ALL	65	70
Vinegar	ALL	65	70
Water (Distilled)	ALL	C	C

NR = Not recommended for the Concentrations and Temperatures listed.

GRP Australia believes the data to be true and accurate but no guarantee is expressed or implied as to specific performance. Testing for specific environments is recommended. Responsibility for claims arising from breach of warranty, negligence or otherwise is limited to the purchase price of the material sold.

STRUCTURAL SECTIONS

PRODUCT GUIDE

34

10.0 GALLERY

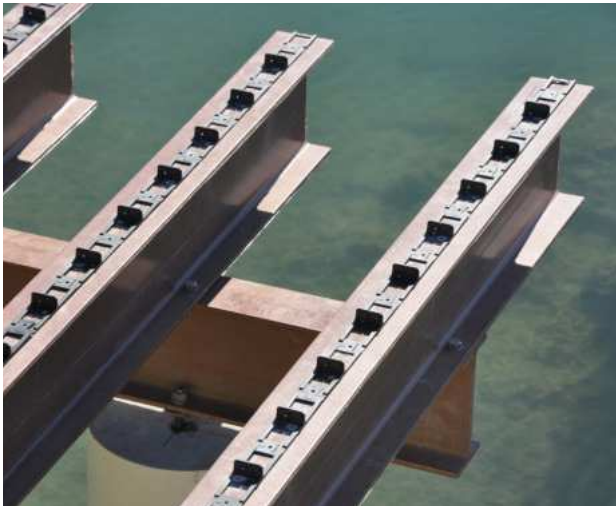



STRUCTURAL SECTIONS

PRODUCT GUIDE

36





GRP AUSTRALIA

L: 25 Shannon Place, Virginia 4014

E: sales@grpaustralia.com.au

P: 07 3252 1244